



## TUNNEL LIGHT ARTEMIS SERIES



### Product Characteristics:

1. Original creation of build-in chimney effect thermal management system takes the lead internationally.
2. Simple and reliable snap-in type chamber opening and closing structure for driver compartment, fast plug in /out design for wiring ensure efficient and convenient maintenance and replacement.
3. Modular patented structure integrating with independent dust proof, water proof, heat dissipation and optical component; available as standard parts to achieve power seriation requirement by increase or reduce the quantity of modular.

### Application

High Mast, Tunnel, Gas Station

Item No	KS-BY2R028A2M2	KS-BY2R042A2M2	KS-BY2R056A2M2	KS-BY2R070A2M2
Input Voltage	AC100~277V	AC100~277V	AC100~277V	AC100~277V
Frequency Range	50/60Hz	50/60Hz	50/60Hz	50/60Hz
System Consumption	61W	91W	122W	153W
LED Initial Flux	5566 Lm	8349 Lm	11132 Lm	13915 Lm
Power Efficiency	0.92	0.92	0.92	0.92
Power Factor	>0.95	>0.95	>0.95	>0.95
Luminaire Efficiency	>90%	>90%	>90%	>90%
Color Temperature	5000-6000K	5000-6000K	5000-6000K	5000-6000K
Color Rendering Index	Ra>75	Ra>75	Ra>75	Ra>75
Operation Environment	Temp. -40°C ~ +50°C, Humidity 10%~95%			
IP Rating	IP65	IP65	IP65	IP65
Lifetime	>50000H	>50000H	>50000H	>50000H
Net Weight	7.5kg	8.0kg	9.5kg	10kg

Item No	KS-BY2R084A2M2	KS-BY2R098A2M2	KS-BY2R112A2M2	KS-BY2R126A2M2
Input Voltage	AC100~277V	AC100~277V	AC100~277V	AC100~277V
Frequency Range	50/60Hz	50/60Hz	50/60Hz	50/60Hz
System Consumption	183W	214W	244W	275W
LED Initial Flux	16698 Lm	19473 Lm	22257 Lm	25039 Lm
Power Efficiency	0.92	0.92	0.92	0.92
Power Factor	>0.95	>0.95	>0.95	>0.95
Luminaire Efficiency	>90%	>90%	>90%	>90%
Color Temperature	5000-6000K			
Color Rendering Index	Ra>75	Ra>75	Ra>75	Ra>75
Operation Environment	Temp. -40°C ~ +50°C, Humidity 10%~95%			
IP Rating	IP65	IP65	IP65	IP65
Lifetime	>50000H	>50000H	>50000H	>50000H
Net Weight	10.6kg	11.2kg	11.8kg	12.4kg

### Installation Sketch:

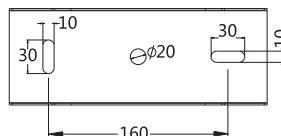

### Polar Intensity Diagram:

